

ILLINOIS ROAD

ILLINOIS ROAD

WEST JEFFERSON BOULEVARD - US 24

APPLE GLEN BOULEVARD

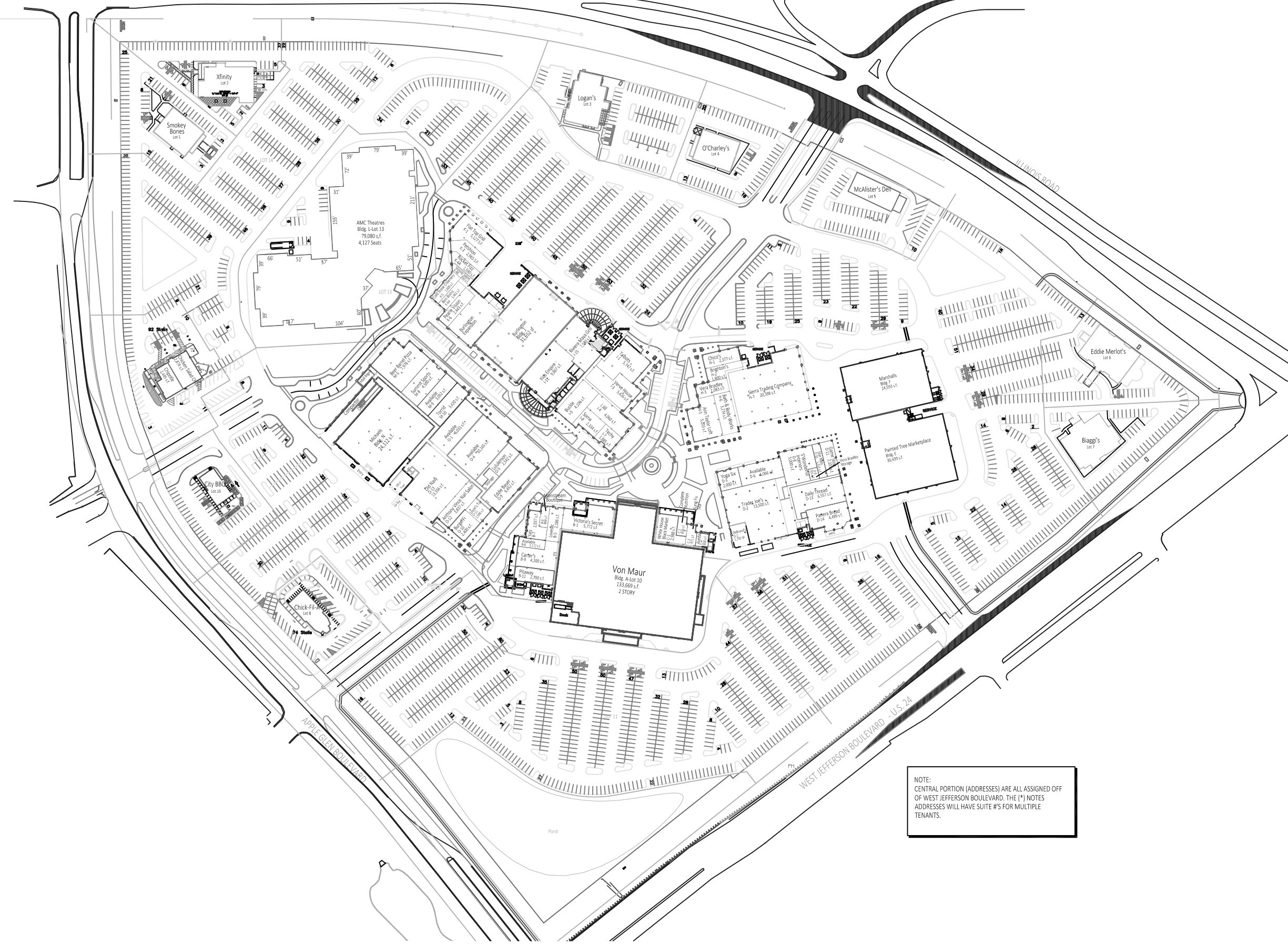

NOTE:
CENTRAL PORTION (ADDRESSES) ARE ALL ASSIGNED OFF
OF WEST JEFFERSON BOULEVARD. THE (*) NOTES
ADDRESSES WILL HAVE SUITE #'S FOR MULTIPLE
TENANTS.

JEFFERSON POINTE SHOPPING CENTER
FORT WAYNE, IN.
SITE PLAN



NOTE:
UNASSIGNED TENANT SPACES ARE
SUBJECT TO CHANGE BASED ON
CONTINUED LEASING ACTIVITY.

DIMENSIONS ARE FROM LEASE LINE TO
LEASE LINE AND DO NOT REFLECT
CONSTRUCTION DOCUMENT DIMENSIONS.

PROJECT OPENED	
UPDATED	Nov 30, 2024
SCALE	NOT TO SCALE



Site Plan
n.t.s.